



RM-65-HC

Glass Door Merchandiser with Swing Door



RM-65-HC
04/08/24
Item # 13463

W x D x H

78" x 29.75" x 78"



RM-65-HC-BLK



RM-65-HC



RM-65-HC-WHT



ANSI / NSF 7



Dimensions / Capacity

Interior Storage Capacity (CF)	Three Section RM-65-HC 56.04 ft ³
Overall Width x Depth	78" x 29.75"
Height	78"
Depth with Door Open	53.25"
Adjustable Shelves	5 per section
Shelf Dimensions (W x D)	(Center) 27.3" x 21.7" / (L&R) 22.4" x 21.7"
Crated Shipping Weight	800 lbs.
Crated Length x Depth x Height	81" x 32.25" x 84"

Electrical / Refrigeration

Voltage	Three Section RM-65-HC 115/60/1
HACR Breaker	15.0 Amps
Electrical Connection (NEMA)	5-15P Ⓢ
Voltage Range	104-126
Ambient Temp. Range	60° to 86°F
Control Setpoint Range	28° to 40°F
Amperage	8.2
Energy Consumption (kWh/day) @ASHRAE	5.67
Approx. Nominal Compres. BTU/HR (HP)	(Left) 1217 (1/3HP) / (Right) 1217 (1/3HP)
Refrigerant / Charge Amount (oz)	R290/(4.10oz.) / R290/(4.10oz.)

Options

- Organizer shelf
- Price tag holder
- Epoxy Shelf

Requires 2 sets of:
 4" Casters (HS-5288)

Warranty

3 Year - Parts and Labor on entire machine.
5 Year - Parts on Compressor
Valid in United States, Canada, Puerto Rico and U.S. Territories. Contact factory for warranty in other countries.

Item #: _____
Project: _____
Qty: _____
AIA#: _____

Features

- ▶ Curved vertical corners with silver/black/white aluminum exterior provide enhanced product display
- ▶ Forced air evaporator for quick temperature pull down
- ▶ Energy saving hot gas loop on front edge of cabinet helps prevent condensation

- Listed under NSF/ANSI Standard 7 for the storage and/or display of packaged or bottled products.
- Large glass doors are energy efficient Low-E multi pane glass with locks
- Doors are standard with locks
- (5) white epoxy coated shelves per section with product stops are standard
- LED illuminated exterior graphic display
- Energy efficient vertical LED interior lights illuminate products on display
- Door is mounted on heavy duty hinges with self-closing mechanism
- Silver painted aluminum exterior with NSF approved white steel interior and stainless steel floor
- Time initiated automatic defrost
- Environmentally friendly CFC-Free Polyurethane insulation with cyclopentane blowing agent.
- Stainless steel shelf clips adjustable in 1/2" increments on anodized aluminum supports
- Refrigerant flow is controlled with a capillary tube
- 8 Foot cord and plug
- 2 inch leveling legs standard
- Exterior finish available in silver, white, and black

Capacity:
20 oz. bottles: 830
12 oz. bottles: 1926

Container Qty: 14

If GFCI is required, a GFCI breaker MUST be used in lieu of GFCI receptacle
Hoshizaki reserves the right to change specifications without notice.



RM-65-HC

Glass Door Merchandiser with Swing Door

RM-65-HC
04/08/24
Item # 13463

FRONT VIEW

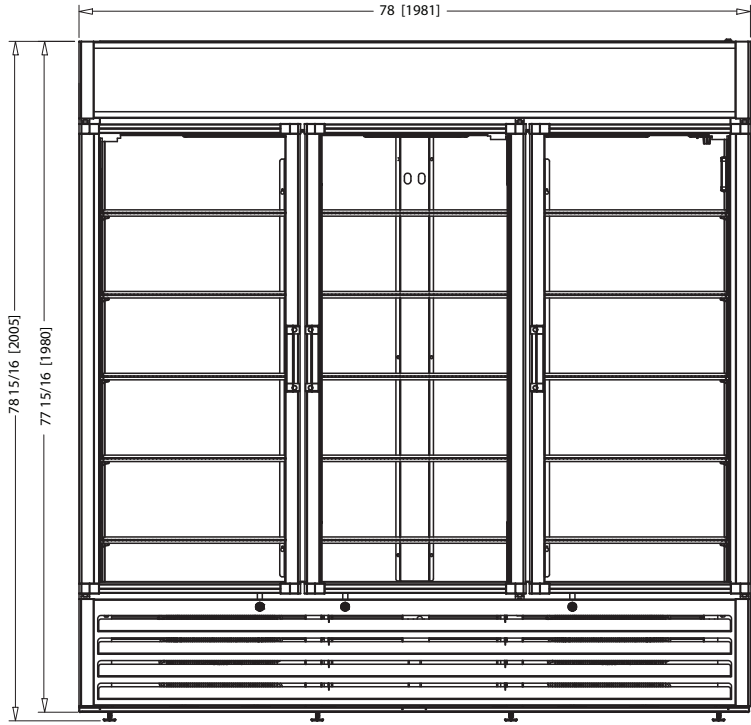

SIDE VIEW

inch [mm]

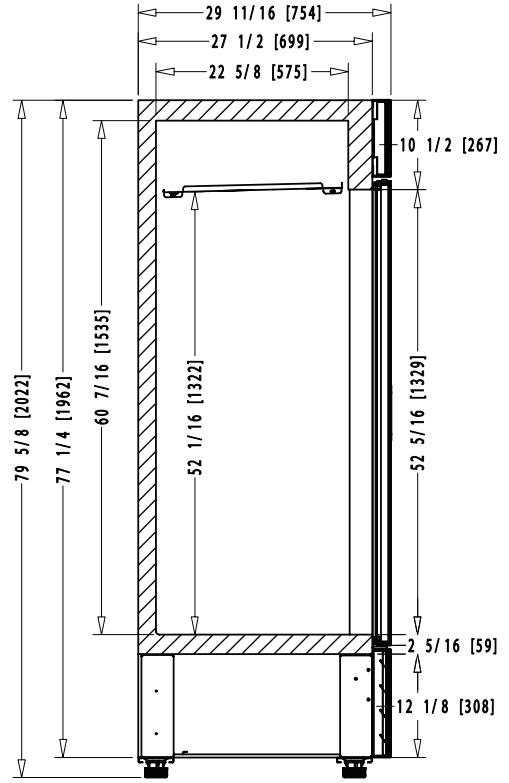

PLAN VIEW

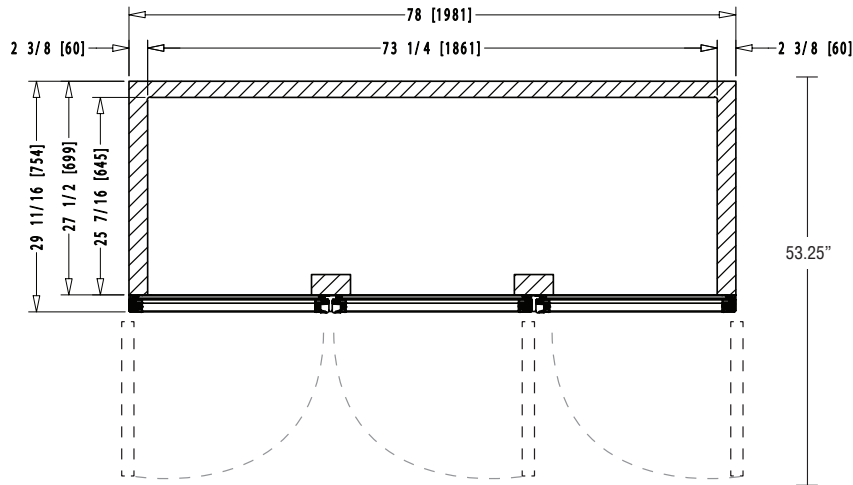

HEADER DIMS

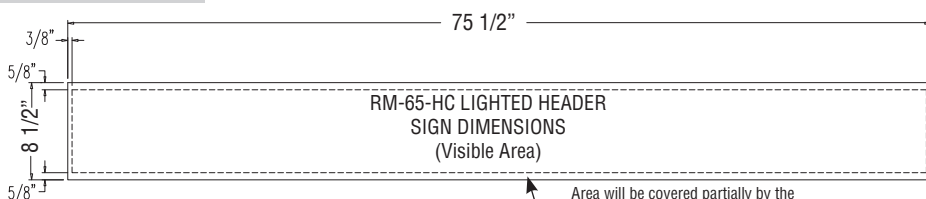

Area will be covered partially by the sign frame, but should have a bleed of graphics background.

Note: Texts and important parts of the image should be within the visible area. The visible area is illustrated by dotted lines when it applies.

Graphic Requirements:

- 360 dpi resolution. Scale 1=1
- Graphics must be saved in photoshop (with layers) (or your sign company file type requirements)
- Colors for CMYK process
- Image with 1/4" of excess by side
- Include a full color print out

Material Requirements:

- Thickness: 1/16" (1.5mm)
- Good- Acrylic/Pexiglass, Better - high impact acrysteel, acrylite SG Best- Super impact Lexan, Lexan SG Polycarbonate