



# HR24C-G

## Compact Undercounter Glass Door Reach-in Refrigerator



HR24C-G  
06/04/21  
Item # 13596

### W x D x H

23.4" x 24.7" x 31.5"

## HR24C-G

ADA Compliant 



Item #: \_\_\_\_\_  
 Project: \_\_\_\_\_  
 Qty: \_\_\_\_\_  
 AIA#: \_\_\_\_\_

## Features

- ▶ **Stainless steel interior and exterior front, sides and top**
- ▶ **UL approved for outdoor use**
- ▶ **Interior LED lighting**

- Stainless steel exterior door with aluminum interior comes standard with locks
- Field reversible door with full length tubular handle
- Magnetic door gasket is easily removable for cleaning
- Environmentally friendly insulation
- Electronic controls with LED Temperature Display and Audio/Visual Alarm
- High and low temperature alarms as well as "Door Open" alarm
- Automatic time-initiated defrost
- (3) Epoxy coated shelves standard
- 9 ft. cord and 5-15P NEMA plug
- Three year parts and labor warranty



### Dimensions / Capacity

|  |  |
|--|--|
| <b>Interior Storage Capacity</b> (CF) (AHAM) | <b>One Section HR24C-G</b><br>3.87 ft <sup>3</sup> |
| <b>Overall Width x Depth (with handle)</b>   | 23.4" x 26.5"                                      |
| <b>Height</b>                                | 31.5"  |
| <b>Depth with Door Open at 90°</b>           | 46.7"  |
| <b>Adjustable Shelves</b>                    | 3  |
| <b>Shelf Dimensions (W x D)</b>              | (1) 18.5" x 17" , (2) 18.5 x 12"                   |
| <b>Crated Weight</b>                         | 115 lbs.   |
| <b>Crated Shipping Dimensions (WxDxH)</b>    | 26.8" x 24" x 36.6"                                |

### Electrical / Refrigeration

|   |   |
|---|---|
| <b>Voltage</b>                              | <b>One Section HR24C-G</b><br>115/60/1  |
| <b>HACR Breaker</b>                         | 15.0 Amps   |
| <b>Electrical Connection (NEMA)</b>         | 5-15P  |
| <b>Voltage Range</b>                        | 115-127   |
| <b>Ambient Temp. Range</b>                  | 45° to 100°F  |
| <b>Control Setpoint Range</b>               | 34° to 52°F   |
| <b>Amperage</b>                             | 1.1   |
| <b>Energy Consumption (kWh/day) @ASHRAE</b> | 0.64  |
| <b>Heat Rejection (BTU/Hr.) @NSF</b>        | 648   |
| <b>Approx. Nominal Compres. BTU/HR (HP)</b> | 501 (1/8HP)   |
| <b>Refrigerant (charge amount, oz.)</b>     | R600a (0.9 oz.)   |

### Options/Accessories

Wine rack kit

### Warranty

3 Year - parts and Labor on entire machine.

Valid in United States, Canada, Puerto Rico and U.S. Territories. Contact factory for warranty in other countries.

*Hoshizaki reserves the right to change specifications without notice.*



# HR24C-G

Compact Undercounter  
Glass Door Reach-in Refrigerator



HR24C-G  
06/04/21  
Item # 13596

FRONT VIEW

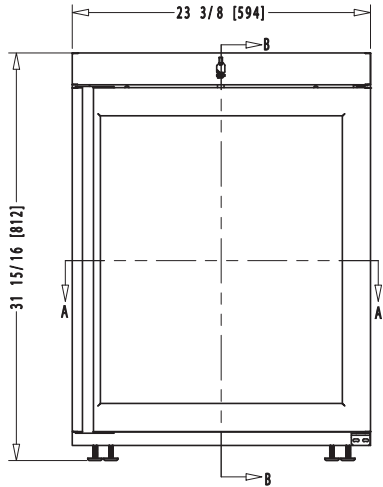

SIDE VIEW

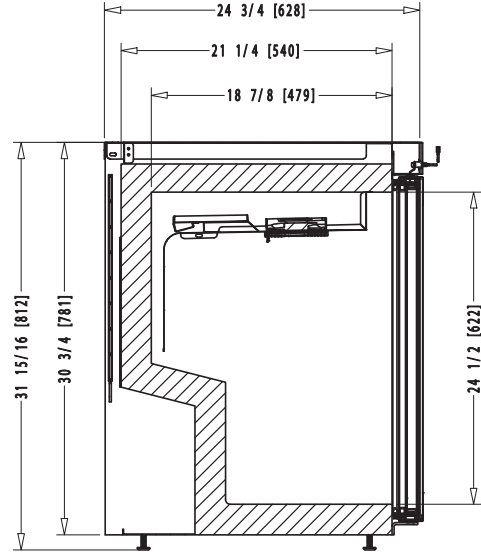

inch [mm]

PLAN VIEW

